





# TEOS+ 100RT

## 1-3kVA

EPO Feature

DSP Control

LCD Display

				
TOWER / RACK	UPS ONLINE	POWER FACTOR	PLUG & PLAY	ECO FRIENDLY



### GENERAL SPECIFICATIONS

- High frequency on-line double conversion technology
- DSP (Digital signal processors) control technology
- Active power factor correction (APFC), input power factor up to 0.99
- Output power factor 0.9
- Wide input voltage range (110 V ~ 300 Vac) and frequency range (40 ~ 70 Hz)
- Auto sensing frequency
- 50/60Hz frequency conversion
- Cold start
- Rear ventilation design and variable speed fan
- Effective software and hardware protection
- Quick and stable charging, 90% capacity restored in 4h (standard model UPS)
- Linear derating in low voltage input reducing battery discharging times
- Settable delayed start when power is restored
- Hot-swappable battery
- Advanced battery management (ABM)
- Multiple functions settable via LCD: output voltage, EOD, autostart, bypass mode, ECO mode and frequency conversion mode
- Multi-platform communications: RS232 (standard), USB / RS485 / SNMP / dry contacts (optional)
- Optional USB, RS485 card, AS400 dry contacts, SNMP card, SMS alarms, EPO function, MBS (External maintenance bypass switch)

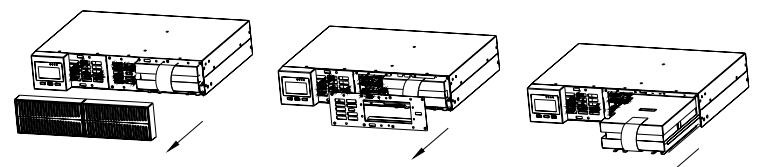
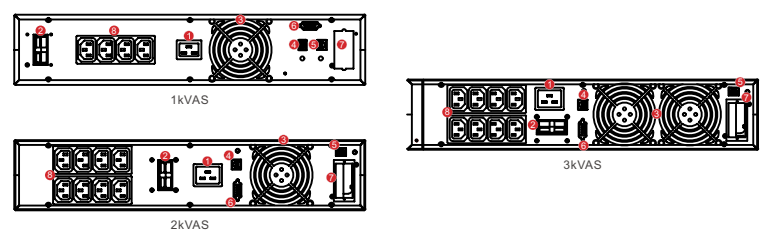

Easy for maintenance, hot-swappable battery

#### REAR PANEL

- |                                 |                     |
|---------------------------------|---------------------|
| 1- AC input socket              | 5- EPO (optional)   |
| 2- Battery connector (optional) | 6- RS232            |
| 3- Fan                          | 7- Intelligent slot |
| 4- USB (optional)               | 8- Output sockets   |

## TECHNICAL SPECIFICATIONS

MODEL	Teos+ 101RT	Teos+ 102RT	Teos+ 103RT	
Power	1 kVA / 900 W	2 kVA / 1800 W	3 kVA / 2700 W	
<b>INPUT</b>				
Rated voltage	208 / 220 / 230 / 240 Vac (settable via LCD)			
Voltage range	110 ~ 176 Vac (linear derating between 50% and 100% load); 176 ~ 280 Vac (no derating); 280 ~ 300 Vac (derating 50%)			
Frequency	40 ~ 70 Hz (auto-sensing)			
Power factor	≥ 0.99			
Bypass voltage range	-25% ~ +15% (settable)			
Total harmonic distortion (THDi)	≤ 6%			
<b>OUTPUT</b>				
Voltage	208 / 220 / 230 / 240 Vac (settable via LCD)			
Voltage regulation	± 1%			
Frequency	45 ~ 55 Hz or 55 ~ 65 Hz (synchronized range); 50 / 60 Hz ± 0.1 Hz (battery mode)			
Waveform	Sinusoidal			
Power factor	0.9			
Total harmonic distortion (THDv)	≤ 2% (linear load); ≤ 5% (non-linear load)			
Crest factor	3:1			
Overload	105% ~ 125% for 1 min, 125% ~ 150% for 30 s, > 150% for 300 ms			
<b>BATTERY</b>				
DC voltage	24V	48V	72V	96V
Inbuilt battery	2x12V/9Ah	4x12V/9Ah	6x12V/9Ah	/
Charging current (max.)	1A			6A
Recharge time	Standard model: 90% capacity restored in 3 hours Long time model: depend on the capacity of battery			
<b>SYSTEM</b>				
Efficiency	≥ 90% (Mains mode)	≥ 91% (Mains mode)	≥ 92% (Mains mode)	
	≥ 85% (Battery mode)	≥ 86% (Battery mode)	≥ 87% (Battery mode)	
	≥ 95% (ECO mode)	≥ 96% (ECO mode)	≥ 97% (ECO mode)	
Transfer time	Mains mode to battery mode: 0 ms Inverter mode to bypass mode: 4 ms (typical)			
Protections	Short-circuit, overload, overtemperature, battery discharge protection and fan testing protection			
Communications	RS232 (standard), USB / RS485 / dry contacts / SNMP (optional)			
Display	LCD + LED			
Standards	EN 62040-1, EN 62040-2, EN 61000-3-2, EN 61000-3-3, IEC 61000-4-2, IEC 61000-4-3, IEC 61000-4-4, IEC 61000-4-5, IEC 61000-4-6, IEC 61000-4-8, IEC 61000-4-11, IEC 61000-2-2, IEC 62040-2, IEC 62040-1			
<b>GENERAL</b>				
Operating temperature	0°C ~ 40°C			
Storage temperature	- 25°C ~ 55°C (without battery)			
Relative humidity	0 ~ 95% (non-condensing)			
Altitude	≤ 1000 m, derating 1% for each additional 100 m			
IP rating	IP 20			
Noise level at 1m	≤ 50 dB			
Dimensions (HxWxD) (mm)	88x440x338	88x440x430	88x440x560	88x440x468
Packaged dimensions (HxWxD) (mm)	194x545x428	201x545x560	201x545x690	88x440x592
Net weight (kg)	10.6	18.7	26.8	10.1
Gross weight (kg)	11.3	21.8	29.7	13.6